

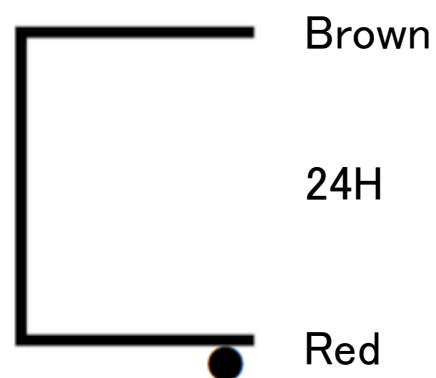

FMC-3210HL
FINEMET® NANOCRYSTALLINE Core Choke

Audio Feast

Wiring Connection



Inductance 32H
Recommended DC current 100mA
Max DC Current 120mA
MAX AC Voltage 900V
DCR 94 ohm
Minimum current for Choke input 30mA
Dimension 100x100x150(H)mm
Black hammered metal case, or Urushi finish

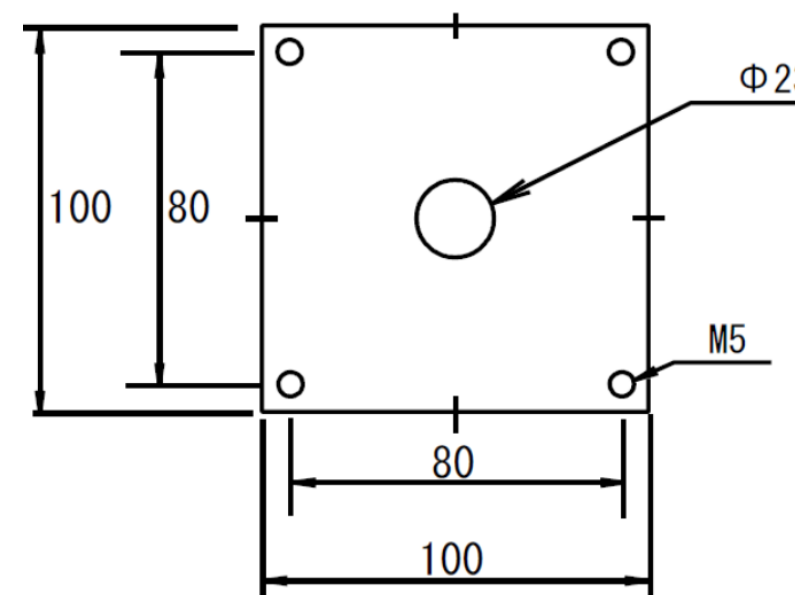
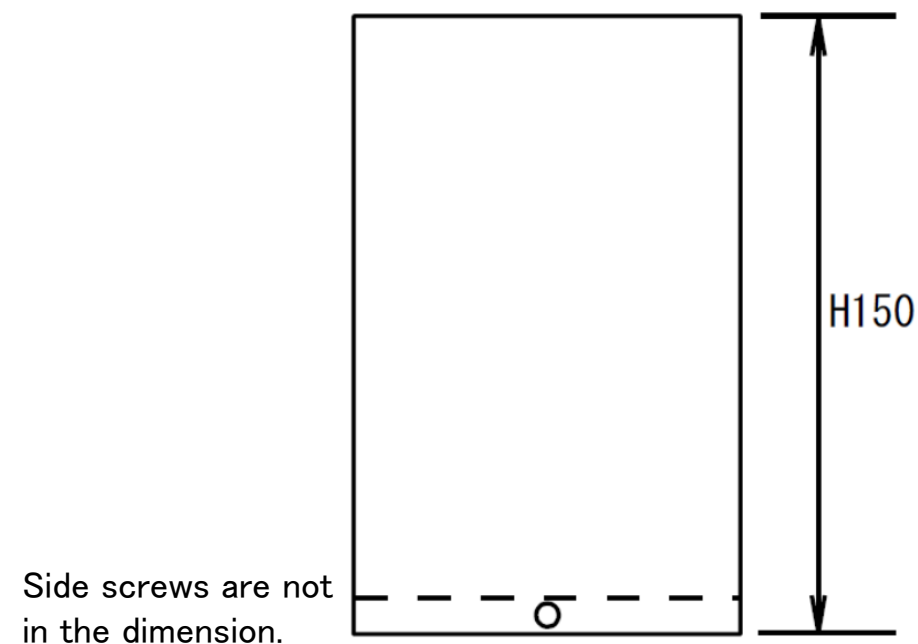

Email: CleanUnderwear@gmail.com

Web: TheAudioFeast.com

Distributed by Audio Feast (Nashville, TN, USA)

Final finish by Teramoto (Myoko, Japan)

Designed by General Ind. (Saitama, Japan)